

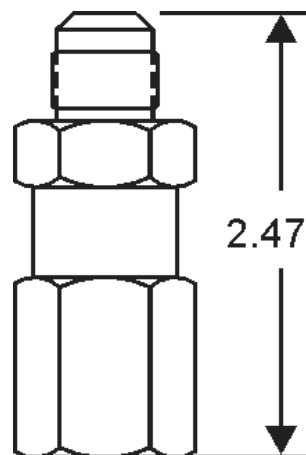

We recommend the use of our Reservoir Pressure Valve with our Oil Reservoir. Mount the valve on the 3/8" male flare suction vent on top of the Oil Reservoir. The S-9104 maintains a 5 lb. positive pressure differential in the Oil Reservoir over the crankcase pressure. This positive pressure will insure an adequate oil supply to the Oil Level Regulators. The oil level in all the Oil Level Regulators is calibrated at this 5 lb. positive pressure. Some parallel compressor systems have a satellite compressor which maintains a higher suction pressure than the other compressors in the system. The S-9104H provides a 20 lb. positive pressure in the Oil Reservoir for this application.

For applications that have long periods of non-run time, overnight for example, the use of the S-9104H is recommended. During low usage periods the oil return line from the separator may become flattened to crankcase pressure, thus losing feed differential and oil return. the use of a 20 psi diff valve will result in less chance of the oil system flattening over time.



Catalog Number	Pressure Setting	Size Connection
S-9104	5 lbs.	3/8" Female Flare x 3/8" Male Flare
S-9104H	20 lbs.	3/8" Female Flare x 3/8" Male Flare