

SHUT-OFF VALVES

Globe Design



Features:

- **Valve Bodies:** Cast bronze
- **Valve Bonnets:** Forged brass
- **Seal Caps:** Molded valox
- **Stems:** Acme threaded, plated steel or stainless steel
- **Backseating:** Can be repacked under pressure
- **Non-Rotating** self aligning swivel seat disc with fully retained Teflon seat ring
- **Valve Size:** Identification cast on valve body
- **Temperature Range:** -40°F(-40°C) to +325°F (+163°C)
- **Maximum cold working pressure:** 450 PSI (31 Kg/cm²)
- **Bonnet Threaded** to accept seal cap
- **Suitable for refrigerants** and other industrial fluids non-corrosive to steel and brass



Type 203,
Globe Type

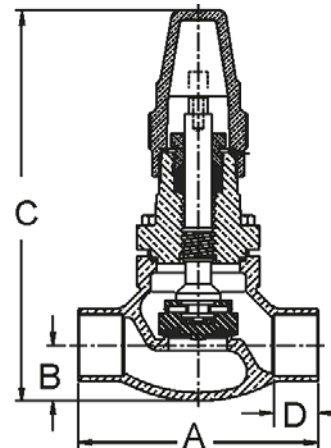

Catalog Number	O.D.S. Connection	Dimensions in Inches				* CV Valve	Weight lbs.
		A	B	C	D		
2030-AA	7/8"	4.25	.97	5.62	.75	5.3	3.00
2030-BA	1-1/8"	4.88	1.14	5.88	.94	7.4	4.68
2031	1-3/8"	5.38	1.25	8.75	1.00	10.8	7.35
2032	1-5/8"	6.50	1.50	9.94	1.13	13.3	10.40
2033	2-1/8"	8.50	2.00	10.63	1.50	22.0	16.69
2034	2-5/8"	11.00	2.25	11.94	1.69	36.3	28.12
2035	3-1/8"	12.00	2.63	13.25	1.75	52.0	44.00

* CV Valve—GPM Water @ standard conditions and 1 psi pressure drop